

alle  
blox

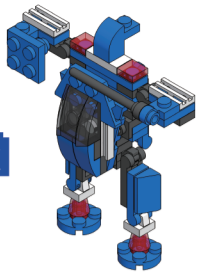

- x2 [white 1x1 brick with hole]
- x2 [blue 1x2 brick]
- x2 [blue 1x3 brick]
- x2 [blue 1x4 brick]
- x4 [black 1x2 brick]
- x2 [white 1x2 brick with hole]
- x2 [white 1x3 brick with hole]
- x5 [black 1x4 brick]
- x2 [red 1x2 brick]
- x2 [blue 1x2 brick]
- x2 [white 1x2 brick with hole]
- x2 [red 1x2 brick]
- x2 [black 1x2 brick]
- x3 [red 1x2 brick]
- x2 [blue 1x2 brick]
- x4 [black 1x2 brick]
- x1 [blue 1x2 brick]

- A1
- x1 [black 1x2 brick]
  - x2 [black 1x2 brick]
  - x1 [black 1x2 brick]

- A2
- x1 [black 1x2 brick]
  - x1 [black 1x2 brick]
  - x2 [black 1x2 brick]
  - x2 [blue 1x2 brick]

- A3
- x2 [blue 1x2 brick]
  - x2 [blue 1x2 brick]
  - x2 [white 1x2 brick with hole]

- A4
- x2 [red 1x2 brick]
  - x2 [black 1x2 brick]
  - x2 [black 1x2 brick]
  - x1 [black 1x2 brick]

- A5
- x1 [blue 1x2 brick]
  - x1 [blue 1x2 brick]
  - x2 [black 1x2 brick]
  - x1 [black 1x2 brick]
  - x1 [blue 1x2 brick]

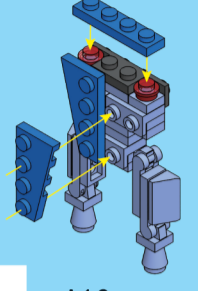
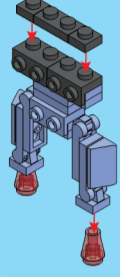
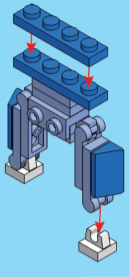
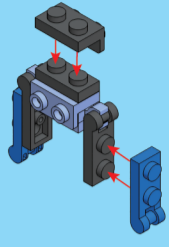
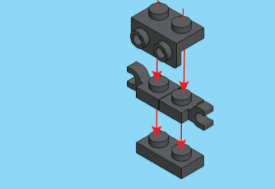

- A6
- x1 [blue 1x2 brick]
  - x2 [white 1x2 brick with hole]
  - x2 [black 1x2 brick]
  - x2 [black 1x2 brick]
  - x2 [black 1x2 brick]

- A7
- x1 [blue 1x2 brick]
  - x1 [grey 1x2 brick with hole]
  - x2 [blue 1x2 brick]
  - x1 [blue 1x2 brick]
  - x2 [blue 1x2 brick]

- A8
- x1 [blue 1x2 brick]
  - x1 [blue 1x2 brick]
  - x1 [blue 1x2 brick]
  - x1 [red 1x2 brick]
  - x2 [red 1x2 brick]
  - x2 [white 1x2 brick with hole]
  - x2 [white 1x2 brick with hole]

- A9
- x2 [white 1x2 brick with hole]
  - x1 [blue 1x2 brick]
  - x1 [blue 1x2 brick]
  - x1 [black 1x2 brick]
  - x2 [blue 1x2 brick]

- A10
- x1 [blue 1x2 brick]
  - x1 [blue 1x2 brick]
  - x2 [black 1x2 brick]
  - x1 [black 1x2 brick]
  - x1 [blue 1x2 brick]

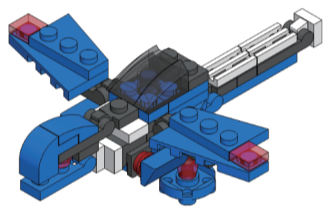
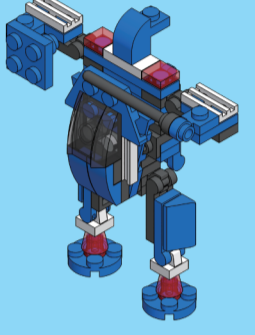
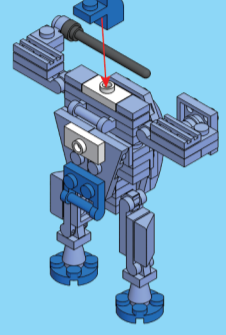
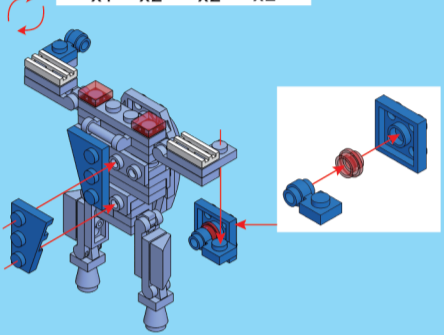
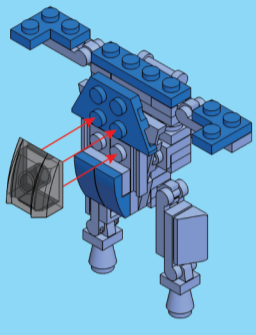
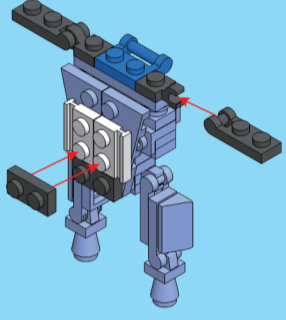

- B1
- x2 [black 1x2 brick]
  - x2 [blue 1x2 brick]
  - x1 [black 1x2 brick]
  - x1 [blue 1x2 brick]

- B2
- x2 [red 1x2 brick]
  - x2 [blue 1x2 brick]
  - x1 [black 1x2 brick]
  - x2 [blue 1x2 brick]
  - x2 [red 1x2 brick]

- B3
- x1 [blue 1x2 brick]
  - x1 [black 1x2 brick]
  - x1 [black 1x2 brick]
  - x2 [blue 1x2 brick]
  - x1 [black 1x2 brick]

- B4
- x1 [black 1x2 brick]
  - x1 [blue 1x2 brick]
  - x1 [white 1x2 brick with hole]
  - x2 [white 1x2 brick with hole]

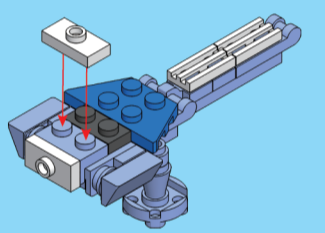
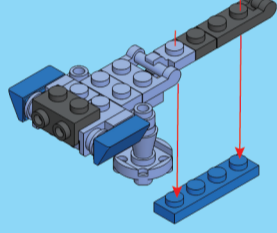
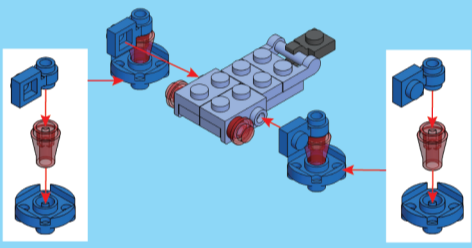
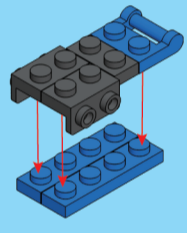

- B5
- x1 [blue 1x2 brick]
  - x2 [black 1x2 brick]
  - x2 [white 1x2 brick with hole]
  - x2 [black 1x2 brick]

- B6
- x1 [blue 1x2 brick]
  - x1 [black 1x2 brick]
  - x1 [blue 1x2 brick]
  - x1 [blue 1x2 brick]

- B7
- x1 [red 1x2 brick]
  - x1 [blue 1x2 brick]
  - x1 [black 1x2 brick]
  - x1 [black 1x2 brick]
  - x1 [blue 1x2 brick]
  - x2 [blue 1x2 brick]

- B8
- x1 [blue 1x2 brick]
  - x1 [blue 1x2 brick]
  - x1 [black 1x2 brick]
  - x1 [grey 1x2 brick with hole]
  - x1 [blue 1x2 brick]
  - x2 [red 1x2 brick]

- B9
- x1 [blue 1x2 brick]
  - x1 [blue 1x2 brick]
  - x2 [black 1x2 brick]
  - x1 [black 1x2 brick]
  - x1 [blue 1x2 brick]

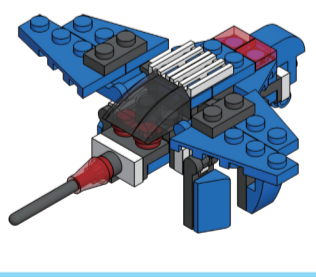
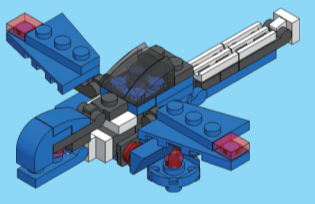
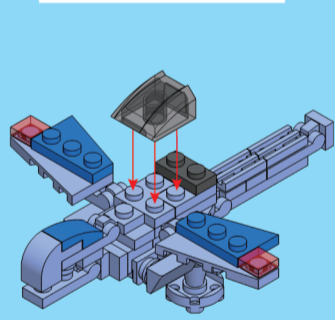
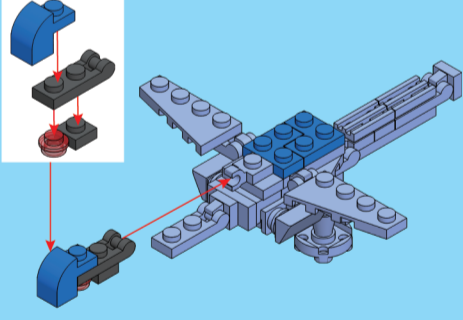
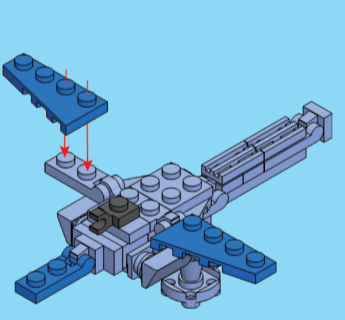
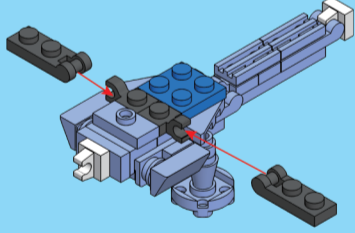

- C1
- x2 [black 1x2 brick]
  - x2 [blue 1x2 brick]
  - x1 [blue 1x2 brick]
  - x2 [blue 1x2 brick]

- C2
- x2 [black 1x2 brick]
  - x2 [black 1x2 brick]
  - x1 [black 1x2 brick]

- C3
- x2 [white 1x2 brick with hole]
  - x2 [black 1x2 brick]
  - x2 [blue 1x2 brick]
  - x2 [black 1x2 brick]

- C4
- x1 [black 1x2 brick]
  - x2 [white 1x2 brick with hole]
  - x1 [black 1x2 brick]
  - x2 [red 1x2 brick]

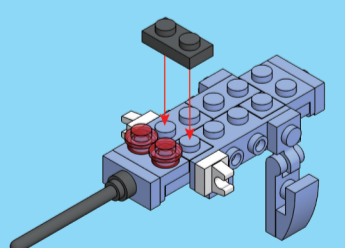
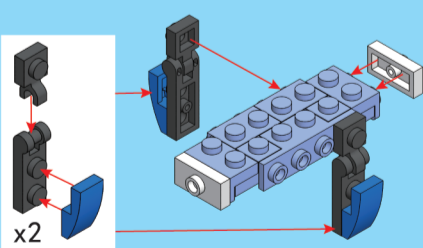
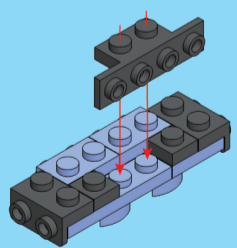
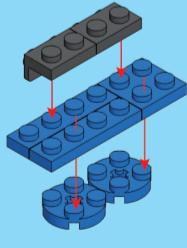

- C5
- x2 [blue 1x2 brick]
  - x1 [blue 1x2 brick]
  - x2 [black 1x2 brick]
  - x1 [red 1x2 brick]

- C6
- x1 [grey 1x2 brick with hole]
  - x1 [blue 1x2 brick]
  - x1 [black 1x2 brick]
  - x2 [black 1x2 brick]
  - x2 [red 1x2 brick]

- C7
- x1 [blue 1x2 brick]
  - x1 [blue 1x2 brick]
  - x2 [blue 1x2 brick]
  - x2 [blue 1x2 brick]
  - x1 [blue 1x2 brick]

- C8
- x1 [blue 1x2 brick]
  - x1 [blue 1x2 brick]
  - x1 [blue 1x2 brick]
  - x2 [black 1x2 brick]
  - x2 [white 1x2 brick with hole]
  - x1 [blue 1x2 brick]

- C9
- x1 [blue 1x2 brick]
  - x1 [blue 1x2 brick]
  - x2 [black 1x2 brick]
  - x1 [black 1x2 brick]
  - x1 [blue 1x2 brick]

